



Parent's Guide

Peppa Pig Learning Watch



© ABD Ltd/Ent. One UK Ltd 2003.
91-003758-000 (US)

INTRODUCTION

Thank you for purchasing the **VTech® Peppa Pig Learning Watch**.

Play number games and more with the **Peppa Pig Learning Watch**! Peppa Pig makes learning fun with games that feature counting, comparing, sorting and matching. Keep the learning right at hand!

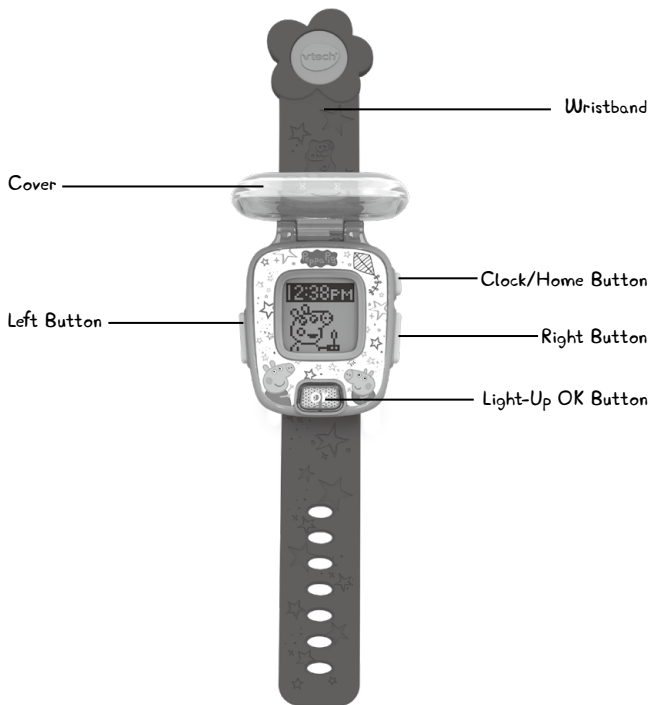

INCLUDED IN THIS PACKAGE

- One Peppa Pig Learning Watch
- One CR2450 battery (placed inside the product)
- One parent's guide

WARNING:

All packing materials, such as tape, plastic sheets, packaging locks, removable tags, cable ties and packaging screws are not part of this toy, and should be discarded for your child's safety.

NOTE: Please keep this parent's guide as it contains important information.

ATTENTION :

Pour la sécurité de votre enfant, débarrassez-vous de tous les produits déballage tels que rubans adhésifs, feuilles de plastique, attaches, étiquettes et vis déballage. Ils ne font pas partie du jouet.

NOTE : Il est conseillé de conserver ce guide des parents car il comporte des informations importantes.

PRODUCT SPECIFICATION

BATTERY	One CR2450 battery
TIME FORMAT	12h or 24h
DISPLAY	DIGITAL
OPTIMUM OPERATING AND CHARGING TEMPERATURE	32°F - 104°F (0°C - 40°C)

Important Note:

- Do not place the watch under running water.
- Do not submerge. Not suitable for showering, bathing or swimming.
- Keep the cover closed when the watch is not in use.

Note :

- Ne pas mettre la montre sous l'eau.
- Ne pas immerger la montre et ne pas l'utiliser sous la douche et dans le bain.
- Garder le clapet fermé lorsque la montre n'est pas utilisée.

WARNING:

People with very sensitive skin may notice some irritation after wearing the Peppa Pig Learning Watch for extended periods of time. The skin may become irritated when moisture, sweat, soap or other irritants get trapped under the wristband and are left in contact with the skin. To prevent this, we suggest children remove the watch before going to bed for the night, take the watch off if it's feeling uncomfortable, and keep their wrist and the band clean and dry.

In addition, wearing the watch too tightly may also cause irritation. Make sure the fit is tight enough so the watch stays in place but not so tight that it's uncomfortable. If you notice any redness, swelling, or other irritation, you may want to consult a doctor before wearing the watch again.

PRÉCAUTIONS D'UTILISATION

Comme avec d'autres objets portés près du corps de manière prolongée, la montre interactive pourrait éventuellement provoquer une irritation. L'humidité, la transpiration, l'eau savonnée ou d'autres agents irritants peuvent s'incruster sous le bracelet et rester en contact avec la peau.

En prévention, nous recommandons fortement aux enfants de ne pas porter la montre pendant la nuit, de l'enlever dès le moindre signe d'irritation, et de garder le bracelet sec et propre. Par ailleurs, vérifiez que le bracelet de votre enfant ne soit ni trop serré, ni trop lâche. Si vous observez des rougeurs, gonflements ou autre irritation, veuillez consulter un médecin avant de remettre la montre.

GETTING STARTED

⚠ WARNING:

This product contains a button or coin cell battery. A swallowed button or coin cell battery can cause internal chemical burns in as little as two hours and lead to death. Dispose of used batteries immediately. Keep new and used batteries away from children. If you think batteries might have been swallowed or placed inside any part of the body, seek immediate medical attention.

⚠ ATTENTION !

Ce jouet contient une pile bouton ! L'ingestion d'une pile bouton peut causer des brûlures internes pouvant provoquer la mort dans un délai de 2 heures. Jeter les piles usées immédiatement après les avoir retirées du jouet. Garder les piles neuves hors d'atteinte des enfants. Si vous remarquez qu'une pile bouton a été avalée, consultez immédiatement un médecin.

POWER SOURCE

The Peppa Pig Learning Watch operates using a CR2450 battery. The CR2450 battery included with the product is for demo purposes only.

BATTERY INSTALLATION

NOTE: For best performance, remove the factory-installed battery from the Peppa Pig Learning Watch and use a new battery.

1. Locate the battery cover on the back of the unit and open it with a screwdriver (not included).
2. Remove the battery cover and insert a new CR2450 battery as illustrated.
3. Replace the battery cover and fasten the screw.

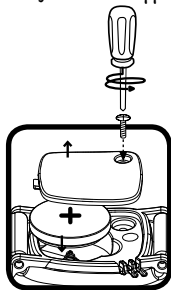

BATTERY NOTICE

- Use one CR2450 Lithium coin battery only for this toy. Do not use a rechargeable Lithium ion battery LIR2450. This toy is not compatible with LIR2450.
- The coin battery used with this product should be kept away from small children who might still put things in their mouths. If the coin battery is swallowed, consult a doctor immediately.
- Insert the coin battery with the correct polarity.
- Do not use damaged coin battery.
- Do not short-circuit the coin battery terminals.
- Remove exhausted coin battery from the toy.
- Remove coin battery during long periods of non-use.
- Do not dispose of coin battery in fire.
- Do not charge non-rechargeable coin battery.
- Remove rechargeable batteries from the toy before charging (if removable).
- Rechargeable batteries are only to be charged under adult supervision.

TO BEGIN USING THE PEPPA PIG LEARNING WATCH

When you use the watch for the first time, open the cover, then press the **Left + Right + OK Buttons** for approximately 5 seconds to unlock the Try-Me mode. You will hear three beeping sounds when the Try-Me mode is unlocked. You can then press any button to activate the watch and set the time.

Press the **Left or Right Buttons** to select, then press the **OK Button** to confirm and move to the next option. A checkmark will be displayed when the setting is complete.

Note:

- When the battery level is low, most functions on the watch may not be activated, except for the clock display. It is recommended to replace with a new battery as soon as possible before further use.
- If the battery level is too low and cannot keep the clock running, you will need to enter the time and date again after the battery has been replaced.

ACTIVITIES & FEATURES

Cover

Open the cover to view the time. When the cover is closed, tap the bottom of the cover to activate Peppa Pig phrases with a fun light effect.

Left/Right Buttons

Use the **Left** or **Right Buttons** to select an activity or option, or to select option five in settings or navigate through the games.

Light-Up OK Button

Press the **Light-Up OK Button** to confirm a selection and move to the next option in an activity.

Clock/Home Button

Press the **Clock/Home Button** to return to the clock from any other function or activity.

Clock Display

When the **Clock/Home Button** is pressed, the time will be displayed. Press the **Left** or **Right Buttons** to display the **Home Menu** where other activities and settings can be selected.

Home Menu

Press the **Left** or **Right Buttons** to display the **Home Menu**. There are five options to choose from:

1. Alarm Clock 	2. Stopwatch 	3. Timer 
4. Games 	5. Settings 	

- Press the **Left** or **Right Buttons** to scroll through the menu options.
- Press the **OK Button** to confirm.

Alarm Clock

You can set an alarm with a choice of three alarm tones.

- Press the **Left** or **Right Buttons** to select the time/ alarm tone.
- Press the **OK Button** to confirm and move to the next setting.
- Press the **Clock Button** to automatically save the current setting.



Stopwatch

Access the stopwatch here.

- Press the **OK Button** to start the stopwatch; press again to stop.
- When the stopwatch is stopped, you can press the **Left** or **Right Buttons** to reset.



Timer

Set a countdown timer here.

- Press the **Left** or **Right Buttons** to change the time.
- Press the **OK Button** to confirm.
- When you press the **OK Button** to confirm the timer duration, the countdown will start immediately.
- While the timer is running, you can press the **OK Button** to pause/resume. When it is paused, you can press the **Left** or **Right Buttons** to reset.



Games

In the Games menu, press the **Left** or **Right Buttons** to scroll through the different progressive learning game options:

1. Count With Peppa

Count the number of fish in the tank. Press the **Left** or **Right Buttons** to select the answer, and press the **OK Button** to confirm.



2. Ball & Hoops

Choose the smallest or largest number to shoot the ball into the hoop. Once the ball is under the number hoop you desire, press the **OK Button** to shoot the ball.



3. Fruits or Vegetables

Pick out fruits or vegetables from the conveyor belt. Press the **OK Button** to choose the answer.



4. Matching Shadows

Match the shadow with the correct image of an animal or friend. Press the **Left** or **Right Buttons** to select the answer, then press the **OK Button** to confirm.



Settings

In the Settings menu, press the **Left** or **Right Buttons** to scroll through the various options:

1. Clock Face

- Press the **Left** or **Right Buttons** to select from eight different clock faces.
- Press the **OK Button** to confirm.



2. Cuckoo Clock

- When the Cuckoo Clock is activated, the watch will briefly chime and show the clock at the top of each hour between 7 AM and 7 PM. The Cuckoo Clock will not ring if a game is in progress or the Alarm or Timer is ringing.
- Press the **Left** or **Right Buttons** to turn the Cuckoo Clock **On** or **Off**.
- Press the **OK Button** to confirm.



3. Time Setting

- Press the **Left** or **Right Buttons** to change the options. (Note: The AM/PM setting is only applicable in 12-hour time format.)
- Press the **OK Button** to confirm.



AUTOMATIC POWER OFF

To save power, the **Peppa Pig Learning Watch** will automatically power off when there has been no input for about 30 seconds. Press any button or open the cover to turn the unit **On** again.

The unit will also automatically turn **Off** when the battery power is very low. If you see the **Low Battery** icon appear on screen, please replace the battery.

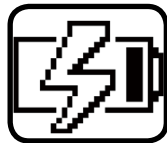

Note: The **Peppa Pig Learning Watch** will not automatically power off when the **Stopwatch** is running.

CARE & MAINTENANCE

1. Keep the unit clean by wiping it with a slightly damp cloth. Never use solvents or abrasives.
2. Keep it out of direct sunlight and away from direct sources of heat.
3. Remove the battery when not using it for an extended period of time.
4. Avoid dropping it. Never try to dismantle it.
5. Always keep the unit away from water.

TROUBLESHOOTING

If for some reason the program/activity stops working or the unit cannot be turned on again, please follow these steps:

1. Turn the unit **Off**.
2. Interrupt the power supply by removing the battery.
3. Let the unit stand for a few minutes, then replace the battery.
4. Turn the unit back **On**. The unit will now be ready to play again.
5. If the unit still does not work, replace with a new battery.

If the problem persists, please call our Consumer Services Department at 1-800-521-2010 in the U.S. or 1-877-352-8697 in Canada, or by going to our website at vtechkids.com and filling out our Contact Us form located under the Customer Support link. A service representative will be happy to help you.

IMPORTANT NOTE:

Creating and developing VTech® products is accompanied by a responsibility that we at VTech® take very seriously. We make every effort to ensure the accuracy of the information, which forms the value of our products. However, errors sometimes can occur. It is important for you to know that we stand behind our products and encourage you to call our Consumer Services Department at 1-800-521-2010 in the U.S. or 1-877-352-8697 in Canada, or by going to our website at vtechkids.com and filling out our Contact Us form located under the Customer Support link with any problems and/or suggestions that you might have. A service representative will be happy to help you.

Note: This equipment has been tested and found to comply with the limits for a Class B digital device, pursuant to Part 15 of the FCC Rules. These limits are designed to provide reasonable protection against harmful interference in a residential installation. This equipment generates, uses and can radiate radio frequency energy and, if not installed and used in accordance with the instructions, may cause harmful interference to radio communications. However, there is no guarantee that interference will not occur in a particular installation. If this equipment does cause harmful interference to radio or television reception, which can be determined by turning the equipment off and on, the user is encouraged to try to correct the interference by one or more of the following measures:

- Reorient or relocate the receiving antenna.
- Increase the separation between the equipment and receiver.
- Connect the equipment into an outlet on a circuit different from that to which the receiver is connected.
- Consult the dealer or an experienced radio/TV technician for help.

Caution: Changes or modifications not expressly approved by the party responsible for compliance could void the user's authority to operate the equipment.

Supplier's Declaration of Conformity

Trade Name: VTech®
Model: 5260
Product Name: Peppa Pig Learning Watch
Responsible Party: VTech Electronics North America, LLC
Address: 1156 W. Shure Drive, Suite 200
Arlington Heights, IL 60004
Website: vtechkids.com

THIS DEVICE COMPLIES WITH PART 15 OF THE FCC RULES. OPERATION IS SUBJECT TO THE FOLLOWING TWO CONDITIONS: (1) THIS DEVICE MAY NOT CAUSE HARMFUL INTERFERENCE, AND (2) THIS DEVICE MUST ACCEPT ANY INTERFERENCE RECEIVED, INCLUDING INTERFERENCE THAT MAY CAUSE UNDESIRE OPERATION.

CAN ICES-3 (B)/NMB-3(B)

**CLASS 1
LED PRODUCT**

**Visit our website for more
information about our products,
downloads, resources and more.**

vtechkids.com

**Read our complete warranty policy online at
*vtechkids.com/warranty***



VTech and the VTech logo TM & © 2020 VTech Holdings Limited.

All rights reserved.

Printed in China.

Peppa Pig © Astley Baker Davies Ltd/Entertainment One UK Ltd 2003.

91-003758-000 (S)